



arthur grace
RESIDENTIAL



172a Kingsmead Road, High Wycombe, HP11 1JB
£1,250 Per Month



Floor Plan

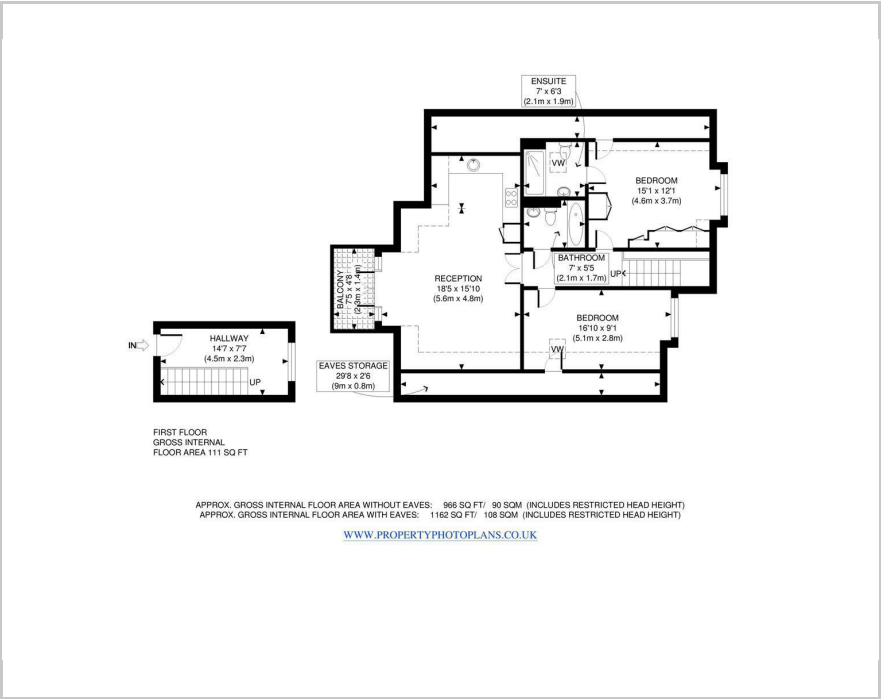

Area Map



Accommodation

- 2 bedroom 2 bathroom apartment
- ** THERE ARE CURRENTLY NO FURTHER VIEWINGS SLOTS AVAILABLE, PLEASE SEND IN AN EMAIL ENQUIRY AND WE WILL REVERT BACK TO YOU SHORTLY **
- Private balcony overlooking rear communal garden
- Allocated parking for 1 car (further parking is available on street, no permit needed)
- Unfurnished (all kitchen appliances included)
- Available from 15th April 2023
- EPC C
- Council Tax. Band C - £1873.89
- 966 sq ft

Energy Efficiency Graph

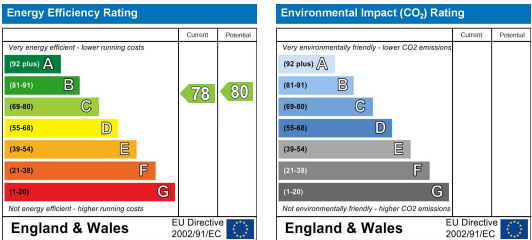

These particulars, whilst believed to be accurate are set out as a general outline only for guidance and do not constitute any part of an offer or contract. Intending purchasers should not rely on them as statements of representation of fact, but must satisfy themselves by inspection or otherwise as to their accuracy. No person in this firm's employment has the authority to make or give any representation or warranty in respect of the property.